

34. Electrical assembly

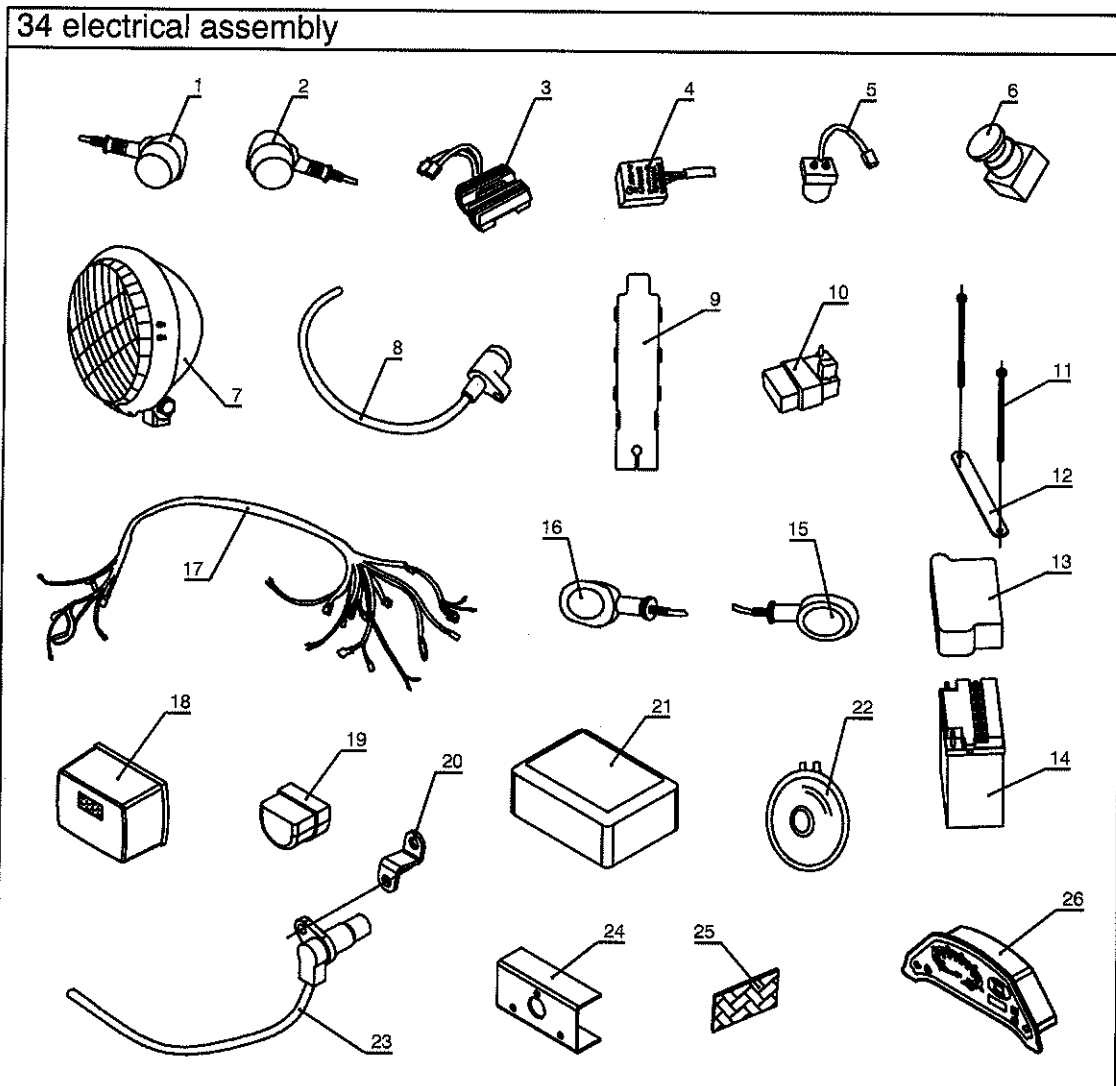

NO.	PART NO.	DESCRIPTION	QUANTITY
1	D650.06.00.05.00	front left turning single	1
2	D650.06.00.15.00	front right turning single	1
3	D250.07.915	voltage regulator	1
4	D650.06.00.10.00	flasher	1
5	D250.07.912	strat relay	1
6	D650.06.00.13.00	mushroom button	1
7	D650.06.00.03.00	head light	2
8	E250.10.03.00.01	high voltage wire	1
9	CF250T-471000	shielding cap	1
10	CF250T-461000	CDI	1
11	5785-M6x110	bolt M6x110	2
12	DN250.10.00.00.03	battery stop band	1
13	DN250.10.00.00.02	battery rubber cove	1

34 electrical assembly

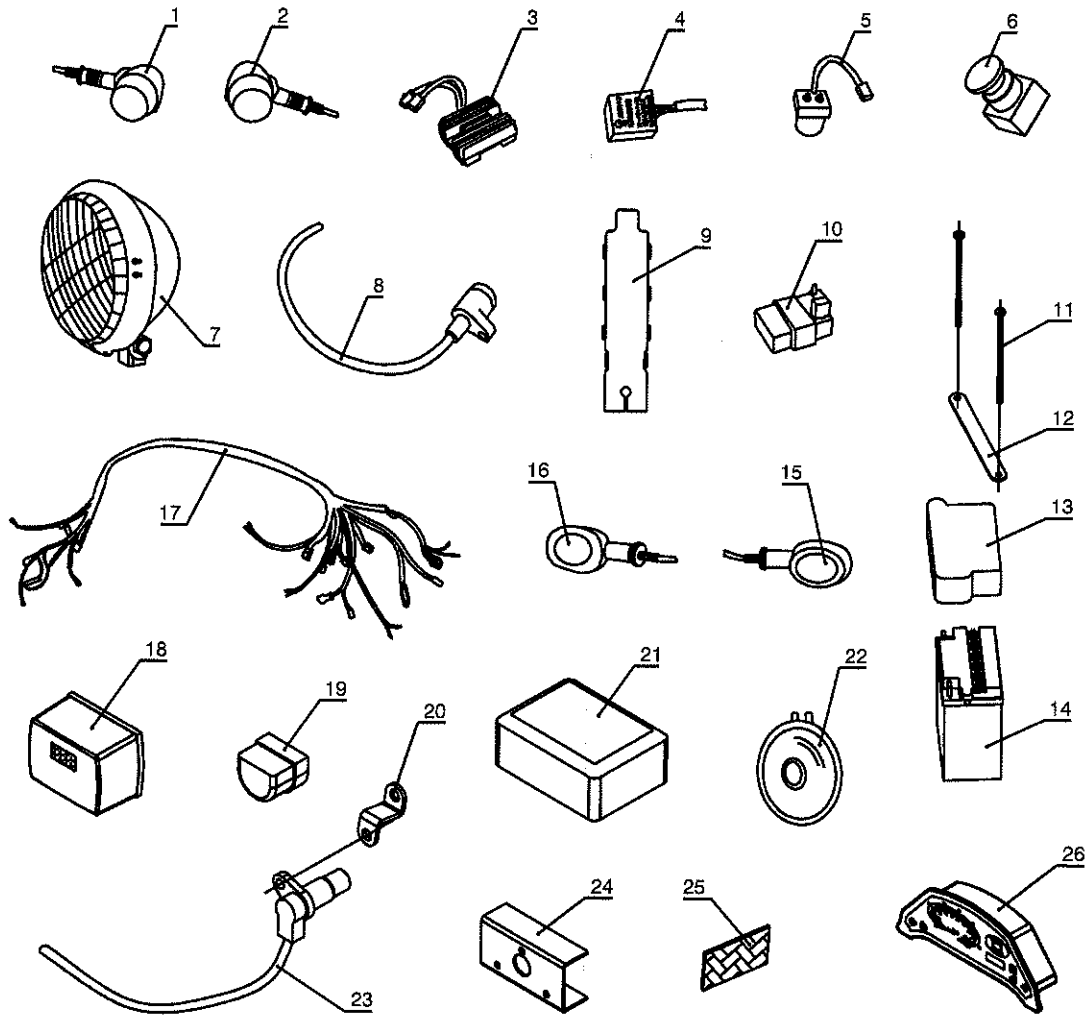

NO.	PART NO.	DESCRIPTION	QUANTITY
14	D250.07.802	battery	1
15	D650.06.00.06.00	rear left turning single	1
16	D650.06.00.16.00	rear right turning single	1
17	E250.10.01.00.00	bale of wire	1
18	D650.06.00.04.00	trail lamp	2
19	E650.06.00.19.00	registration plate light	1
20	DN250.10.00.00.01	speed sensor mounting	1
21	D250.04.901A	electric box	1
22	D650.06.00.09.00	horn	1
23	172MM-B-011300	speed sensor	1
24	C650.06.00.14.00	meter mounting	1
25	E650.08.01.14.00	square reflector	2
26	E250.10.02.00.00	meter	1