

12 CLUTCH ASSY

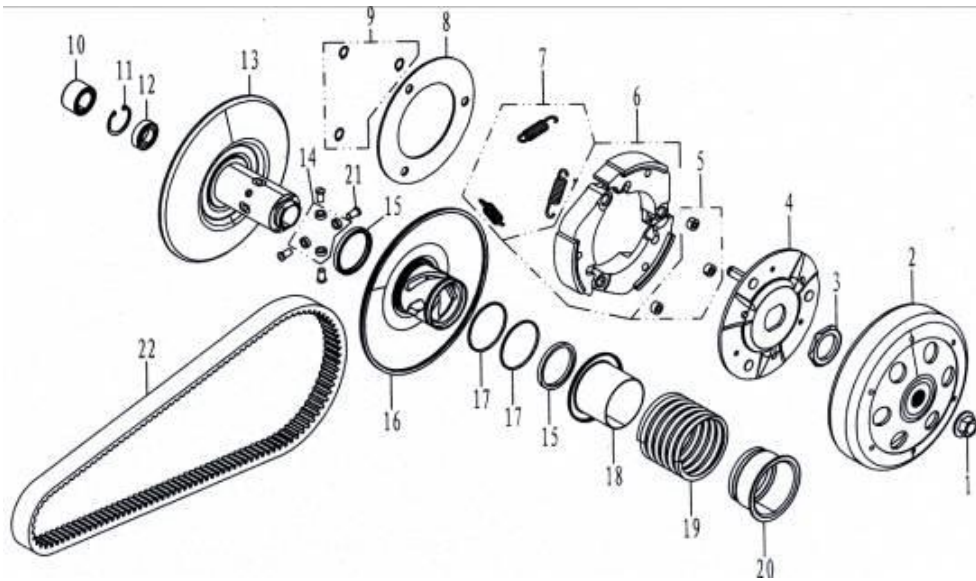

| No. | P/N | ENGLISH | Q'ty |
|-----|-----------------|------------------------|------|
| 1 | 172MM-052008 | BOLT M12X1.25 | 1 |
| 2 | 172MM-A-052500 | OUTTER WHEEL DISC | 1 |
| 3 | 172MM-052005 | THIN NUT M30X1 | 1 |
| 4 | 172MM-A-052400 | DRIVE PAN UNIT | 1 |
| 5 | 172MM-A-052200 | DAMPING RUBBER BLOCK | 3 |
| 6 | 172MM-A-052600 | CLUTCH BLOCK | 3 |
| 7 | 172MM-A-052006 | RELEASE SPRING | 3 |
| 8 | 172MM-A-052003 | SIDE PAN | 1 |
| 9 | 896-SW9 | SPLIT WASHER | 3 |
| 10 | 172MM-052310 | NEEDLE BEARING | 1 |
| 11 | 893.1-RR28 | HOLE RETAINER RING | 1 |
| 12 | 278-B1060902 | BEARING | 1 |
| 13 | 172MM-A-052300 | DRIVEN PAN UNIT | 1 |
| 14 | 172MM-A-052001 | GALLOWS ROLL | 4 |
| 15 | 172MM-A-052104 | DRIVEN PAN GREASE SEAL | 2 |
| 16 | 172MM-A-052100 | MOVABLE DRIVEN PAN | 1 |
| 17 | 3452.1-46.2X1.8 | "O" SEAL RING | 2 |
| 18 | 172MM-A-052007 | SEAL BUSHING | 1 |
| 19 | 172MM-A-052004 | CLUTCH SPING | 1 |
| 20 | 172MM-A-052009 | SLEEVE | 1 |
| 21 | 172MM-A-052002 | GUIDE PIN | 4 |
| 22 | 172MM-B-053000 | COG BELT | 1 |
| | | | |